

# COUNTER TOP DISPLAY

ITEM: \_\_\_\_\_ QUANTITY: \_\_\_\_\_

**MODEL # CTPD**

CTPD - Shown with standard features.

## SPECIFICATIONS

The CTPD is a non-refrigerated curved glass display unit designed for counter top application. Unit is standard with fixed curved front glass.



Available depths:  28 1/2"

Available lengths:  36"  48"  60"  72"  96"

### STANDARD FEATURES

- Standard Grade Laminate Exterior
- Top Canopy Light
- 2 Rows of Tempered Glass Shelves
- White Laminated Deck
- Mirrored Sliding Rear Doors (Swing Doors on the 36")
- 115V/60/Single Phase
- Plexi End Panels

### OPTIONAL FEATURES

- Stainless Steel Exterior Finish
- Special Laminates
- Wood Veneers (Unfinished)
- Wood Veneers (Stained & Sealed)
- Miscellaneous Trim
- Promolux Lighting (Low UV)
- Solid End Panels with Interior Mirrors

**WHEN ORDERING, PLEASE SPECIFY:**

APPLICATION: \_\_\_\_\_

LAMINATE COLOR: \_\_\_\_\_

# COUNTER TOP DISPLAY

TOLL FREE: 800-525-3692

## MODEL # CTPD

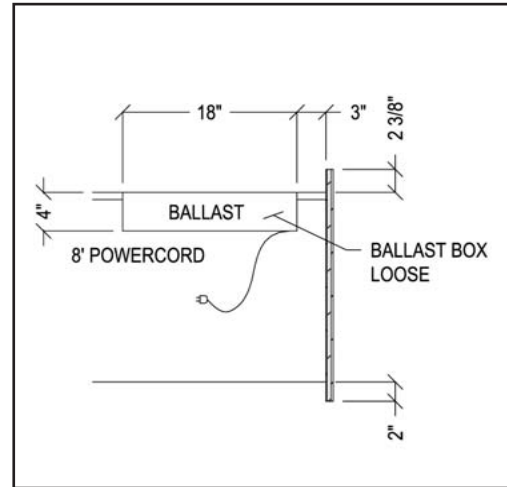
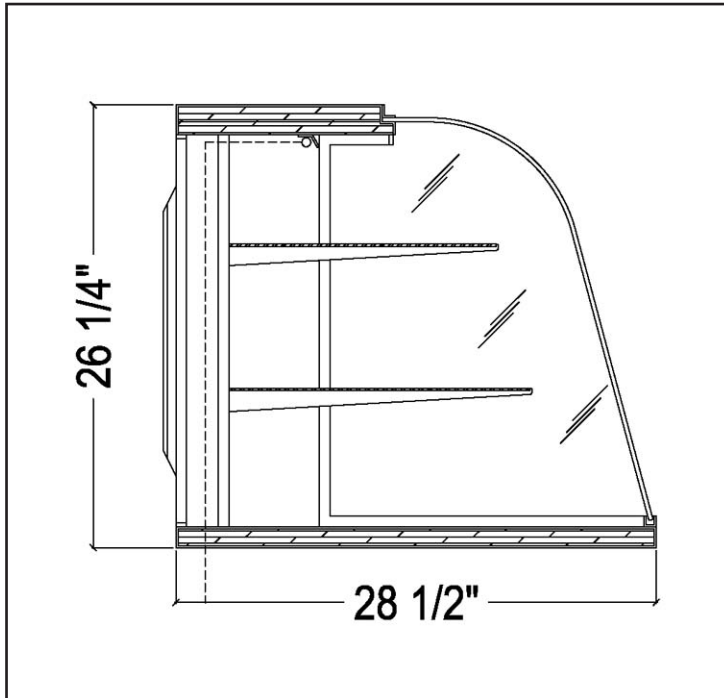

### Electrical & Plumbing locations



Refrigerated Case Display 67C9 Listed  
 Also classified by Underwriters Laboratories Inc.  
 In Accordance with ANSI/NSF 7-1999 and ANSI/NSF 2-1999

MODEL	L	D	H	COMP HP	VOLT	AMP	NEMA PLUG	WT
CTPD36D	36	28 1/2	26 1/4	N/A	115V	2.51	5-15P	140
CTPD48D	48	28 1/2	26 1/4	N/A	115V	2.51	5-15P	200
CTPD60D	60	28 1/2	26 1/4	N/A	115V	2.51	5-15P	260
CTPD72D	72	28 1/2	26 1/4	N/A	115V	2.51	5-15P	315
CTPD96D	96	28 1/2	26 1/4	N/A	115V	2.51	5-15P	420

RPI in line with it's policy to continually improve it's product reserves the right to change materials and specifications without notice.  
 Any adverse conditions will affect warranty.

CALL TOLL FREE: 800-525-3692 (609-714-2330)

FAX: 609-714-2331 [www.regalpinnacle.com](http://www.regalpinnacle.com)

220 ROUTE 70, MEDFORD, NJ 08055

